

# Existing Secondary Suite Floor Plan

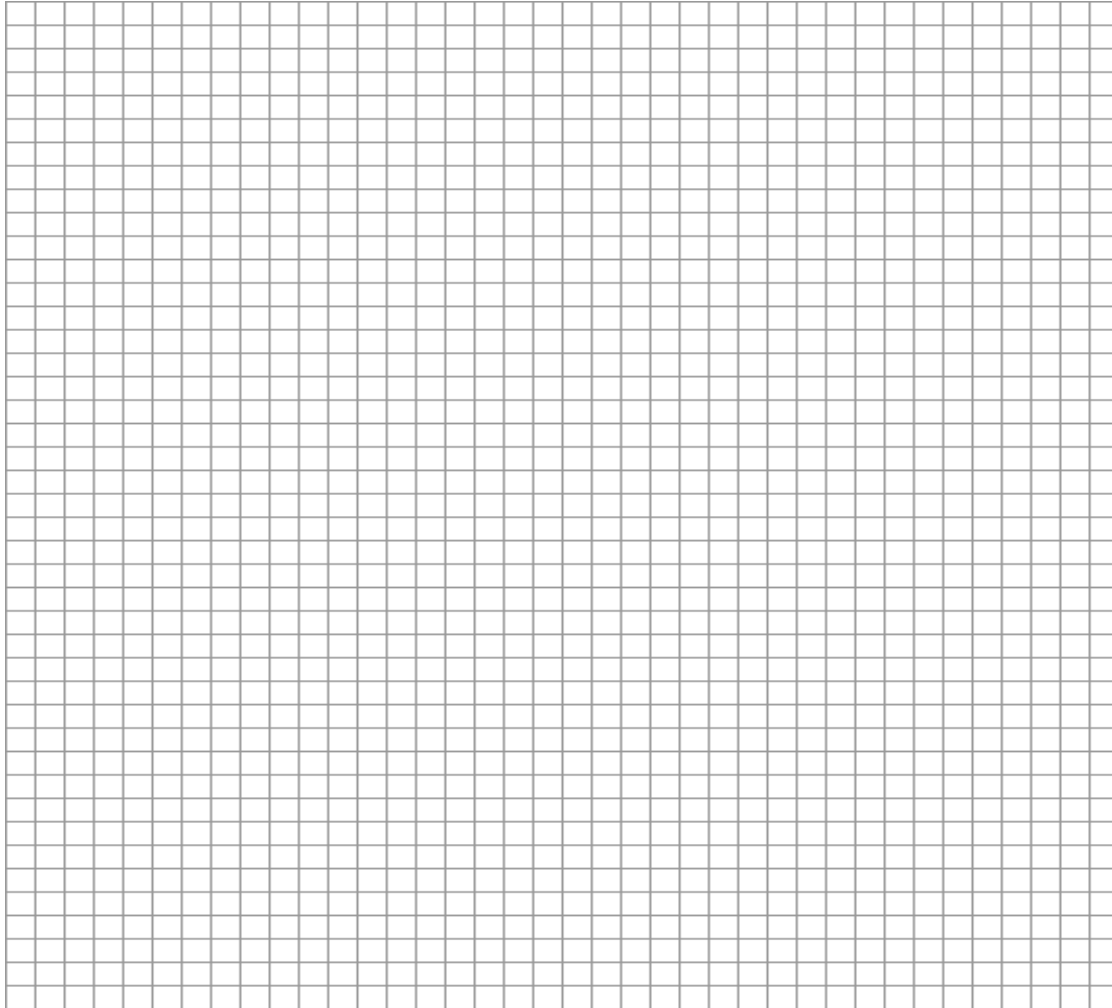

Name: \_\_\_\_\_ Address: \_\_\_\_\_

Date: \_\_\_\_\_ Phone Number: \_\_\_\_\_



Square Footage of Suite: \_\_\_\_\_

Square Footage of House: \_\_\_\_\_

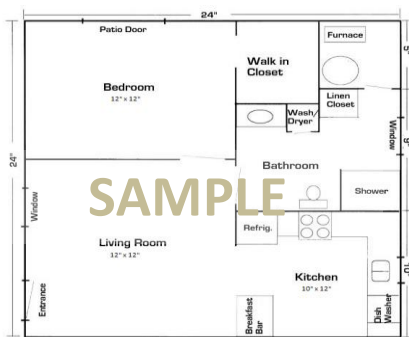

Draw a floor plan of your Secondary Suite using the paper provided. Items that need to be included are as follows:  
**Please note: measurements can be either (standard or metric)**

- ✓ Overall Square footage of Secondary Suite
- ✓ **Dimensions** and name for each room in Suite
- ✓ Window(s) location and **size (Height & Width)**
- ✓ Door(s) location and **size (Interior & Exterior)**
- ✓ Wall locations

For further assistance please contact the Secondary Suite Department: 604-952-3810



The Corporation of Delta  
 Legal Services - Bylaw Enforcement  
 4500 Clarence Taylor Crescent  
 Delta, BC V4K 3E2  
 T 604-952-3159 F 604-952-3803  
 www.corp.delta.bc.ca

suites@corp.delta.bc.ca